



CONTINUING THE  
*legacy of*  
*faith*

ST. JOHN THE BAPTIST  
CATHOLIC CHURCH

*Zachary, Louisiana*

St. John  
“THE DREAM IS NOT  
MERELY THAT OF A  
BUILDING MADE OF  
STONE AND MORTAR;  
IT IS OF BUILDING UP  
A FAITH COMMUNITY  
WHOSE WITNESS,  
STRENGTH AND  
VITALITY WILL INSURE  
THE PRESENCE AND  
IMPORTANCE OF OUR  
CATHOLIC FAITH WELL  
INTO THIS 21ST CENTURY.”



A LETTER FROM  
**from the  
pastor**

Dear Parishioners,

We find ourselves on the brink of a dream that began some ten years ago here in Zachary, and we find ourselves almost 150% percent stronger than when we first began the dream of a *Legacy of Faith*.

The dream is not merely that of a building made of stone and mortar; it is of building up a faith community whose witness, strength and vitality will insure the presence and importance of our Catholic faith well into this 21st century. When we speak of making sacrifice for the benefit of our children, the next generation, the challenges we face are unknown, but the need for our faith to guide us through it is a certainty.

A large part of our growth is based upon people seeking a better life and future for their children, and it is in that hope that we find the necessity for a strong, vibrant faith community to guide them. This is first and foremost what we seek to build, and with that comes our new church that will accommodate our needs and whose beauty will inspire and instruct them on the rich heritage of our Catholic faith.

This will not, and cannot be achieved by any one individual effort, it has to evolve from the generosity and desire of each and every one of our parishioners. Together we can achieve the dream and continue the Legacy.

We will not be able to achieve this only from our comfort or leftovers. It will come from our generosity and willingness to sacrifice for the amount we ask of everyone will not be the same, but the amount of sacrifice we ask of everyone will be. We must be willing to do all that we can if we are to realize our dream.

With the sincere hope that all of you will respond generously and unselfishly, I ask all of you to respond to the request for your presence at our gatherings as well as individual requests to visit with you and to solicit your prayer, your help and your sacrifice.

Yours in Christ,

*Fr. M. Jeffery Bayhi*

Fr. M. Jeffery Bayhi

## OUR challenge

IN 2002, WITH THE GUIDANCE FROM A PARISH ADVISORY BOARD, FATHER KENNETH L. LAIRD REACHED CONSENSUS AMONG OUR CONGREGATION THAT THE PARISH HAD GROWN AND WOULD CONTINUE TO GROW, SUBSTANTIALLY IN THE NEXT TWO DECADES. FROM THAT DECISION, A CAPITAL CAMPAIGN BEGAN WITH THE APPROXIMATELY 480 FAMILIES REGISTERED AT ST. JOHN THE BAPTIST.



By December, 2008, the capital campaign had accrued ~\$1.250 million, just under 50% of the minimum goal originally set. Among the numerous extenuating circumstances that prevented St. John the Baptist from meeting our financial goal were:

1. Medical retirement of Father Laird (Summer, 2005) followed by six-months with temporary administrator, Father Vic Messina
2. Hurricane Katrina (August, 2005)
3. Unexpected departure of our new Pastor (Winter, 2005) followed by six-months with temporary administrator, Monsignor Gerald LeFebvre, until assignment of Father Bayhi (July, 2006)
4. Hurricane Gustav (September, 2008)

Since the capital campaign remained almost dormant during this time period, the finance committee and Father Bayhi agreed to temporarily place the project on hold. In the winter of 2010, Father Bayhi appointed parishioner Billy Kline to head a new Building Committee, which began to re-evaluate the original plan, the reality of a significantly larger congregation (800+ families) and increased construction costs of more than twice the amount projected in 2003 (due not only to inflation but to major storms that caused dramatic increases in overall costs associated with construction throughout Louisiana and Mississippi).



## PROJECT details



TODAY, THERE ARE APPROXIMATELY 1,200 FAMILIES REGISTERED AT ST. JOHN THE BAPTIST. AFTER MUCH PRAYERFUL DISCERNMENT, STUDY AND DISCUSSION AMONG THE BUILDING COMMITTEE, FINANCE COMMITTEE, THE STEWARDSHIP COMMITTEE AND THE DIOCESE OF BATON ROUGE, IT HAS BEEN DECIDED TO UNDERTAKE A PARISH-WIDE CAPITAL CAMPAIGN, CONTINUING THE LEGACY OF FAITH TO RAISE THE FUNDS NECESSARY TO BUILD OUR NEW CHURCH.

Our new church will provide us with the space to comfortably seat 800+ people, plus an additional 40 seats in the cry room. Our new church, which will be constructed in a beautiful Gothic cruciform design, will also have:

- Two reconciliation rooms
- Separate, dedicated choir loft
- Large narthex for community gathering before and after Mass
- Dedicated space for Liturgical Ministry
- Bride's Room/Usher Room
- Updated and energy efficient lighting and HVAC
- Beautiful entrance plaza facing Main Street
- Covered drop-off
- Improved parking with handicapped spaces near the church

In addition to our new church, we will also construct a 40-seat Adoration Chapel that will be connected to the church by a beautifully landscaped cloister.

With the construction of our new church, we have begun to study how St. John the Baptist is able to utilize and repurpose the existing church to meet our growing educational, ministerial and social programs we have here in the parish.



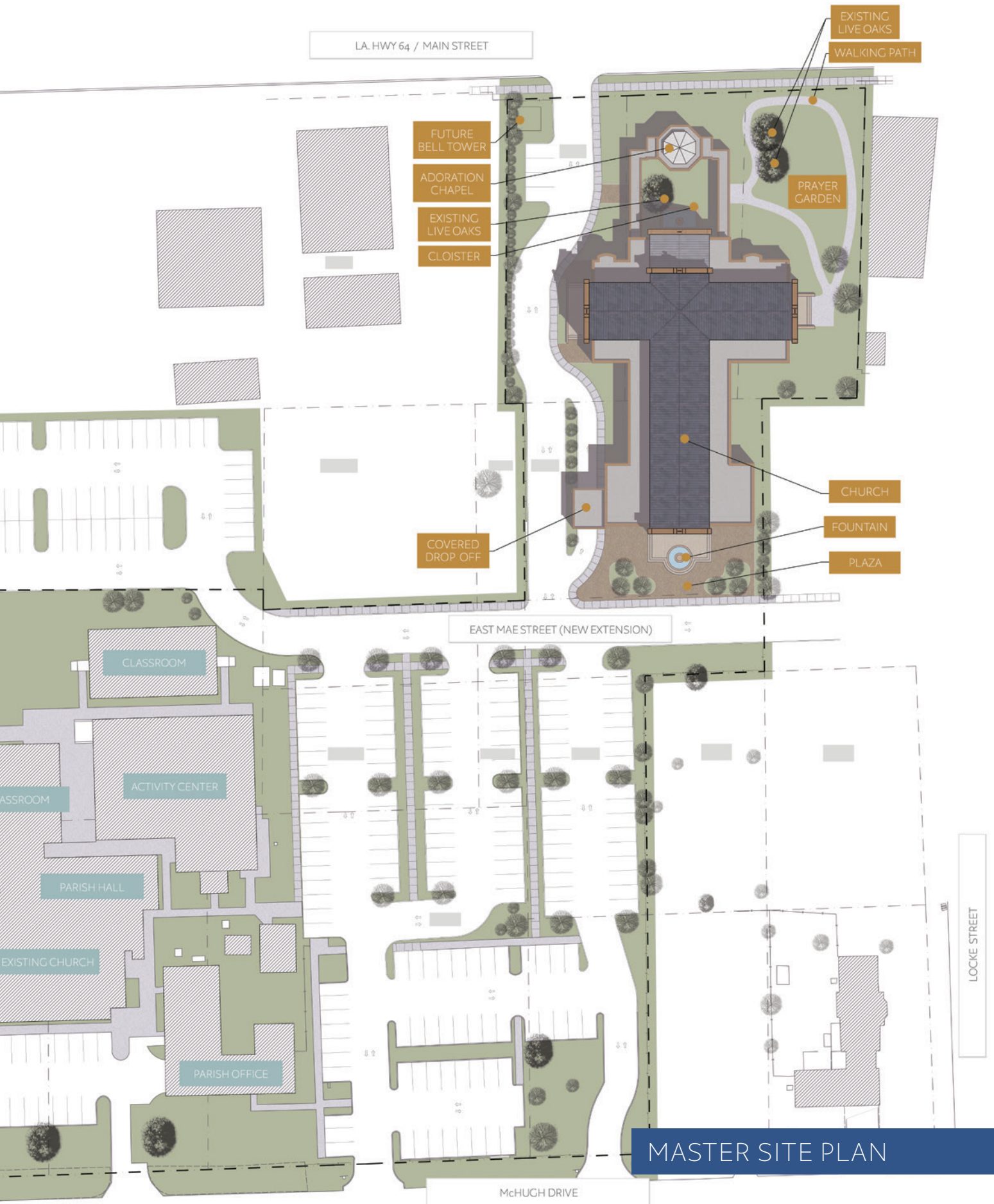

## MASTER SITE PLAN





THE CURRENT ESTIMATED COST OF THE PROJECT ~\$7.5 MILLION. PARISHIONERS AND FRIENDS OF ST. JOHN THE BAPTIST HAVE ALREADY DIRECTED \$2.8 MILLION TOWARD THE OVERALL COST OF THE PROJECT FROM PAST CAMPAIGN EFFORTS AND OUTSIDE SOURCES LEAVING A NEED TO RAISE AN ADDITIONAL \$4.7 MILLION. THE LEADERSHIP OF THE PARISH REALIZES THAT THIS IS A SIGNIFICANT CHALLENGE AND WHILE THERE IS GREAT HOPE AND CONFIDENCE IN THE COMMITMENT AND DEDICATION OF OUR PARISH FAMILY, WE UNDERSTAND THAT WE MUST PLAN ACCORDINGLY IN ORDER TO MAKE THIS DREAM A REALITY.

The goal in this campaign is to raise as much as we can towards our remaining need of \$4.7 Million. We continue to review and consider a variety of additional ways to further fund the new church including the need to potentially conduct an additional campaign in the coming years to completely fund the project.

These are great times for St. John the Baptist. Through all of the obstacles and challenges we have faced during the past ten years, we have remained committed to the task of finally building a place of worship that will be a sign of our faith and love for God and one another for generations to come. It is not every day that a parish community has such an opportunity to build such a firm foundation. Seizing this opportunity and realizing the vision of *Continuing the Legacy of Faith* will not come without sacrifice. Throughout the history of our parish, however, the people of St. John the Baptist have always made the necessary sacrifices in all aspects of parish life and stewardship. We are confident that the building of our new church will be met with the same degree of commitment and participation.

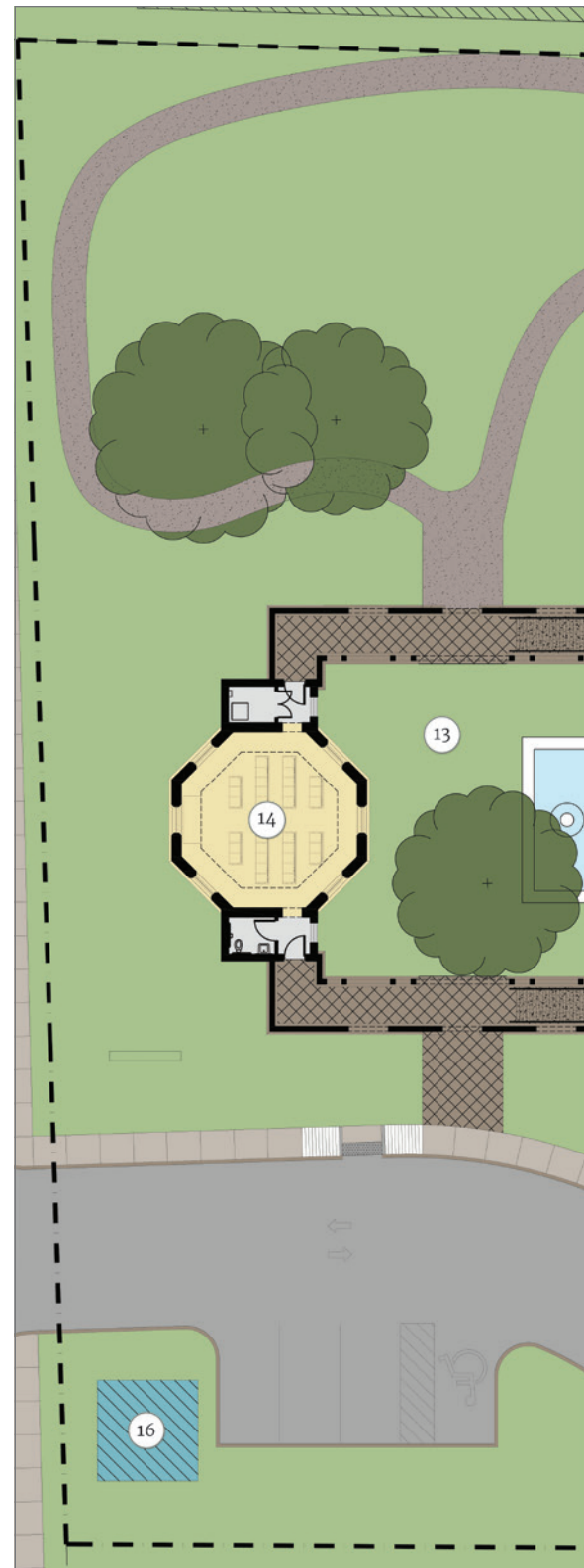



## CHURCH FLOOR PLAN

### CHURCH FLOOR PLAN KEY

- |                          |                      |                       |
|--------------------------|----------------------|-----------------------|
| 1. Fountain              | 8. Tabernacle        | 15. Choir Loft        |
| 2. Entrance              | 9. Cry Room          | 16. Future Bell Tower |
| 3. Narthex               | 10. Confessionals    | 17. Baptismal Font    |
| 4. Liturgical Ministers  | 11. Vesting Room     | 18. Side Altars       |
| 5. Usher's & Bridal Room | 12. Sacristy         |                       |
| 6. Covered Drop Off      | 13. Cloister         |                       |
| 7. Altar                 | 14. Adoration Chapel |                       |





EXTERIOR RENDERING – REAR ENTRANCE



EXTERIOR RENDERING – CHAPEL



# HOW YOU can get involved

---

THROUGHOUT THE  
CONTINUING THE LEGACY  
OF FAITH CAMPAIGN,  
FATHER BAYHI, THE CAPITAL  
CAMPAIGN COMMITTEE  
AND VOLUNTEER WORKERS  
WILL REACH OUT TO  
ALL MEMBERS OF OUR  
COMMUNITY TO CONVEY  
OUR PARISH'S DREAMS FOR  
THE FUTURE AND DESCRIBE  
HOW EVERYONE CAN  
GET INVOLVED. SEVERAL  
IMPORTANT EVENTS ARE  
BEING HELD IN ORDER  
TO GIVE EVERY PARISH  
FAMILY AN OPPORTUNITY  
TO PARTICIPATE.

- 1) Every registered family will be invited to attend one of a series of campaign receptions. These receptions will allow our parishioners the opportunity to gather as a family and to learn about the needs of our parish.
- 2) The families that do not attend a campaign reception will be able to read about our building plans through this campaign brochure, which will be mailed to their homes. These families will also be asked to consider all the information contained in the brochure and then make a prayerful decision about how they will support this effort.
- 3) Those who do not respond by Commitment Weekend will be personally contacted by fellow parishioners, volunteering their time over several weeks for the success of the campaign. These volunteers will be giving their time to undertake the vital task of contacting parishioners and increasing the awareness of this campaign.

## DURING THIS CAMPAIGN, WE ARE ASKING EVERYONE WHO CALLS ST. JOHN THE BAPTIST HOME TO:

1. Pray for the success of the Campaign
2. Be an ambassador for St. John the Baptist by getting involved and by sharing this information with as many people as you can with enthusiasm and encourage them to get involved.
3. Make your sacrificial pledge.

*Whether you participate by attending a campaign reception, responding at Mass or by mail, or by graciously acknowledging our parish volunteers, it is your act of involvement that will make this campaign a success.*

NOT EVERYONE CAN MAKE THE SAME SIZE GIFT  
BUT EVERYONE CAN MAKE THE SAME SIZE SACRIFICE.

# HOW TO pledge your support

---

NO ONE CAN TELL YOU  
HOW MUCH YOU SHOULD  
GIVE. THE INDIVIDUAL  
PARISHIONER/FAMILY  
IS THE ONLY ONE WHO  
ACTUALLY DECIDES WHAT  
TO CONTRIBUTE, SINCE THE  
FINANCIAL OBLIGATIONS  
OF EACH FAMILY ARE  
DIFFERENT. WHAT YOU  
GIVE WILL BE HELD IN THE  
STRICTEST CONFIDENCE.

Currently the parish will need to raise an additional **\$4,700,000** to completely fund the project. Every member of our parish community is integral to our success in reaching this goal, and, therefore, each family is asked to consider making a pledge to the campaign to the best of their ability.

In a perfect world, if each family offered only **\$3.29 a day** for at least three years, we could build a church. However, we do not live in a perfect world. If you can only give **\$100** each month, we thank you. If you can give more, we need you.

## WE NEED YOUR SPECIAL GENEROSITY

Everyone is asked to prayerfully consider how their generosity can reflect their gratitude for the gifts that God has given them. We know that a pledge of at least **\$4,000** will be a challenge for some of our parish households, therefore, it is vital to the success of our campaign that those who are able to make larger pledges do so.

In Deuteronomy 16:10 we are reminded that –  
*“the measure of your own free will offering should be in proportion  
to the blessing the Lord has bestowed on you.”*

*Individuals who are financially capable of pledging \$10,000, \$15,000, \$25,000 or more, are asked to step forward and become leaders of our campaign.* Please review the Suggested Gift Plans on the following page and choose a plan that is right for you and your family.

*The gift plans in this brochure are provided as a suggested guideline when considering your pledge. This campaign will need to receive gifts of all shapes and sizes in order to be successful. Please review the gift plans carefully and select one that fits your family's financial situation. All contributions to the campaign are fully tax deductible for those who itemize their taxes. Pledges are not legally binding, but rather an indication of your intention to donate.*

## YOUR PLEDGE CAN BE GIVEN IN MEMORY OR HONOR OF A LOVED ONE

Memorials are special ways of honoring the people we love, whether they are living or deceased. These memorials are often made for a special intention or in thanksgiving for blessings received from God.

In addition to individual memorial opportunities that will exist, all contributions of \$4,000 or more to this campaign will be recognized on the *Continuing the Legacy of Faith* Memorial, to be displayed prominently in the parish. By choosing a Memorial Gift, you will have the opportunity to make your pledge in the memory or honor of a loved one. This Memorial will serve as a lasting tribute to honor the sacrifices our parishioners generously made. The Memorial will display the name(s) of the person or family who made this level donation and the name or names of those they wish to be remembered. Regardless of the amount of their contribution, every family that participates in the campaign will ultimately be recognized for their commitment to this effort.



## SUGGESTED PLEDGE PLANS

Total Gift	10% Down Payment	3 Annual Payments	6 Semi-Annual Payments	12 Quarterly Payments	36 Monthly Payments	Daily Sacrifice
\$1,000,000	\$100,000	\$300,000	\$150,000	\$75,000	\$25,000	\$821.92
\$500,000	\$50,000	\$150,000	\$75,000	\$37,500	\$12,500	\$401.96
\$250,000	\$25,000	\$75,000	\$37,500	\$18,750	\$6,250	\$205.48
\$100,000	\$10,000	\$30,000	\$15,000	\$7,500	\$2,500	\$82.19
\$50,000	\$5,000	\$15,000	\$7,500	\$3,750	\$1,250	\$41.10
\$25,000	\$2,500	\$7,500	\$3,750	\$1,875	\$625	\$20.55
\$20,000	\$2,000	\$6,000	\$3,000	\$1,500	\$500	\$16.44
\$15,000	\$1,500	\$4,500	\$2,250	\$1,125	\$375	\$12.33
\$10,000	\$1,000	\$3,000	\$1,500	\$750	\$250	\$8.22
\$8,000	\$800	\$2,400	\$1,200	\$600	\$200	\$6.58
\$6,000	\$600	\$1,800	\$900	\$450	\$150	\$4.93
\$5,000	\$500	\$1,500	\$750	\$375	\$125	\$4.11
\$4,000	\$400	\$1,200	\$600	\$300	\$100	\$3.29

## HOW TO make your gift

### PLEDGES VIA CASH OR CHECK

Simply complete your pledge card by selecting the amount of your pledge and down payment (optional, but encouraged). Make sure to select your method of payment, i.e., monthly, quarterly, semi-annual or annual payments. Please make checks payable to **St. John the Baptist Campaign**. You will be mailed payment reminders and a special payment envelope in accordance with the payment plan you choose. Once completed, please return your pledge card in the weekly collection, bring it by the parish office or return it in the mail.

### PLEDGES VIA ONLINE GIVING

To give online, go to [www.sjb-ola.org](http://www.sjb-ola.org), locate the online giving menu and follow the instructions. In addition, please return your pledge card to the campaign office.

### GIFTS OF STOCK

Donors can use their own broker/agent or the parish agent to transfer stock. If the stock has been held long-term (over one year), the donor does not have to pay capital gains tax on the stock, and is allowed a tax deduction for the full value of the stock. Donors may also choose to sell stock in order to claim a loss, which may be beneficial for tax circumstances. In either case, the stock must first be transferred to the parish before being liquidated. Please contact the campaign office for more information.

### GIFTS OF PROPERTY, LIFE INSURANCE, ANNUITIES, WILLS OR BEQUESTS

There are different ways to support St. John the Baptist both today and in the years to come via planned giving. Families or individuals can make gifts of real estate, personal property, automobiles, life insurance, estate bequests, annuities or charitable remainder trusts. For substantial gifts of property other than marketable securities, the IRS requires an appraisal. Please contact the campaign office for more information.

*If you have any questions about the campaign or making your pledge, please contact the parish office, 225.654.5778.*

CONTINUING THE  
**legacy of  
faith**

CAMPAIGN PRAYER

Almighty God and Father,  
You chose St. John the Baptist  
to foretell the coming of Your Son,  
our Savior.

We now pray that You send  
Your Holy Spirit  
to descend upon our parish  
that we might continue  
the work of our patron.

Instill in us the desire to grow in our faith  
and a yearning to live the faith fully  
and to pass it on to  
the generations yet to come.

May our commitment inspire  
others to join us  
in building up Your kingdom  
here in our community,  
now and for years on end.

As we embark upon building  
a place of worship  
that is befitting Your name  
and gives You glory,  
may we work unselfishly  
to build Your church.

May Your Holy Spirit inspire  
a spirit of prayer and generosity  
from all of Your people,  
so that we realize the work  
we seek and accomplish  
is done with Your grace  
and for Your honor.

We ask this and all things  
through Christ our Lord.

*Amen*

ST. JOHN THE BAPTIST  
CATHOLIC CHURCH

4727 McHugh Drive  
Zachary, Louisiana 70791  
225.654.5778  
[www.sjb-ola.org](http://www.sjb-ola.org)

THE THREE FACETS  
**of parish  
giving**

OFFERTORY

Your weekly contributions to the general collection support the day-to-day operating expenses of the parish, including faith formation, Catholic education, liturgy, maintaining our facilities and personnel.

BISHOP'S ANNUAL APPEAL

Each year, parishioners of St. John the Baptist are asked to support the Diocese of Baton Rouge through the Bishop's Annual Appeal in order to supplement the many programs and services offered throughout the diocese for those most in need.

CONTINUING THE LEGACY OF FAITH CAMPAIGN

Your pledge payments to this campaign should be in addition to your regular offertory contributions and annual appeal contributions. Your campaign pledge is a restricted gift — to be used solely for the projects, programs and ministries cited in this brochure.

AS YOU MAKE YOUR PLEDGE PLEASE REMEMBER

- Payments may be made over a period of three (3) years.  
A longer period can be arranged if necessary.
- Payment reminders and a special payment envelope will be mailed to you in accordance with the payment plan you choose.
- Pledge payments are fully deductible for tax purposes.
- Please make checks payable to: St. John the Baptist Campaign

PEOPLE WHO MAKE IT HAPPEN

Many people contribute to the life of our parish and provide vision for our future. Our deepest gratitude extends to the members of the Campaign Committee, who have given the gifts of their time and talents to make this project a success.

*And, of course, we could not have been able to reach out to everyone in our parish if it weren't for the help of our gracious and very dedicated volunteers and parish staff. THANK YOU!*

FUNDRAISING CONSULTANT



**Guidance In Giving, Inc.**

Catholic Stewardship, Development & Campaign Consultants  
P. O. Box 525 / Sayville, NY 11782  
800-509-6054 / [www.guidanceingiving.com](http://www.guidanceingiving.com)